

This instruction manual is for START[®] / ECT[®] Tape Dispenser TDA060 [**BASIC** mode].
 Separate manuals for [**BASIC** mode] , [**ADVANCE** mode] , [**TECHNICAL GUIDE**] ,
 and [**Operating Instructions**] are Downloadable from:



Enclosed:

TDA060 main unit, Reel unit, Power cord, Instruction manual [for **BASIC** mode]

⚠ Warning / Caution

⚠ Warning

- Do NOT insert your fingers into cutting head.
- Keep body parts away from moving parts.
- Do NOT operate the unit near from child.

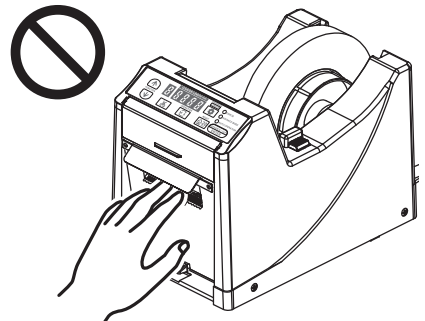

⚠ Caution

- Do NOT cover the unit up with any cloth or paper.
- Do NOT use the unit on an unsteady surface.
- Do NOT disassemble to modify the dispenser.
- Make sure to unplug the unit when moving it or replacing parts.
- Do NOT insert any tools into cutting head.
- Do NOT drop the unit or subject it to heavy shocks.
- Do NOT use volatile liquids (thinner, benzene, etc.) to clean the unit. Wipe with dry cloths only.

⚠ Caution

- ⊘ Do NOT use damaged cable. This may cause a fire or electric failure.
- ⊘ Do NOT operate the unit near from flammable liquids (thinner, benzene, etc.).
- ⊘ Do NOT operate the unit in chlorine / corrosive gases generating place.
- ⊘ Only use enclosed power cord.
- ⓘ Make sure to unload tape after work for preventing tape jamming.

Be sure to attach and use the included "Sensor cover."

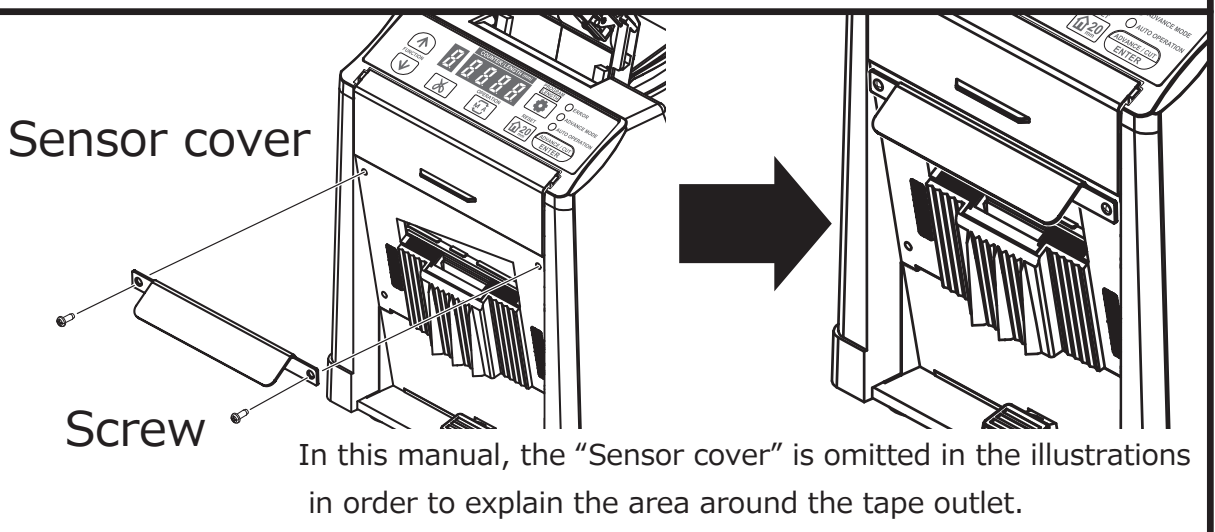

What the unit does?

TDA060 is an industrial tape dispenser for pressure sensitive tapes & some non-adhesive materials, which can feed and cut materials with definite length.

Two different modes can be used for your needs:

For regular /simple operation = **BASIC** mode.

For detail setting = **ADVANCE** mode.

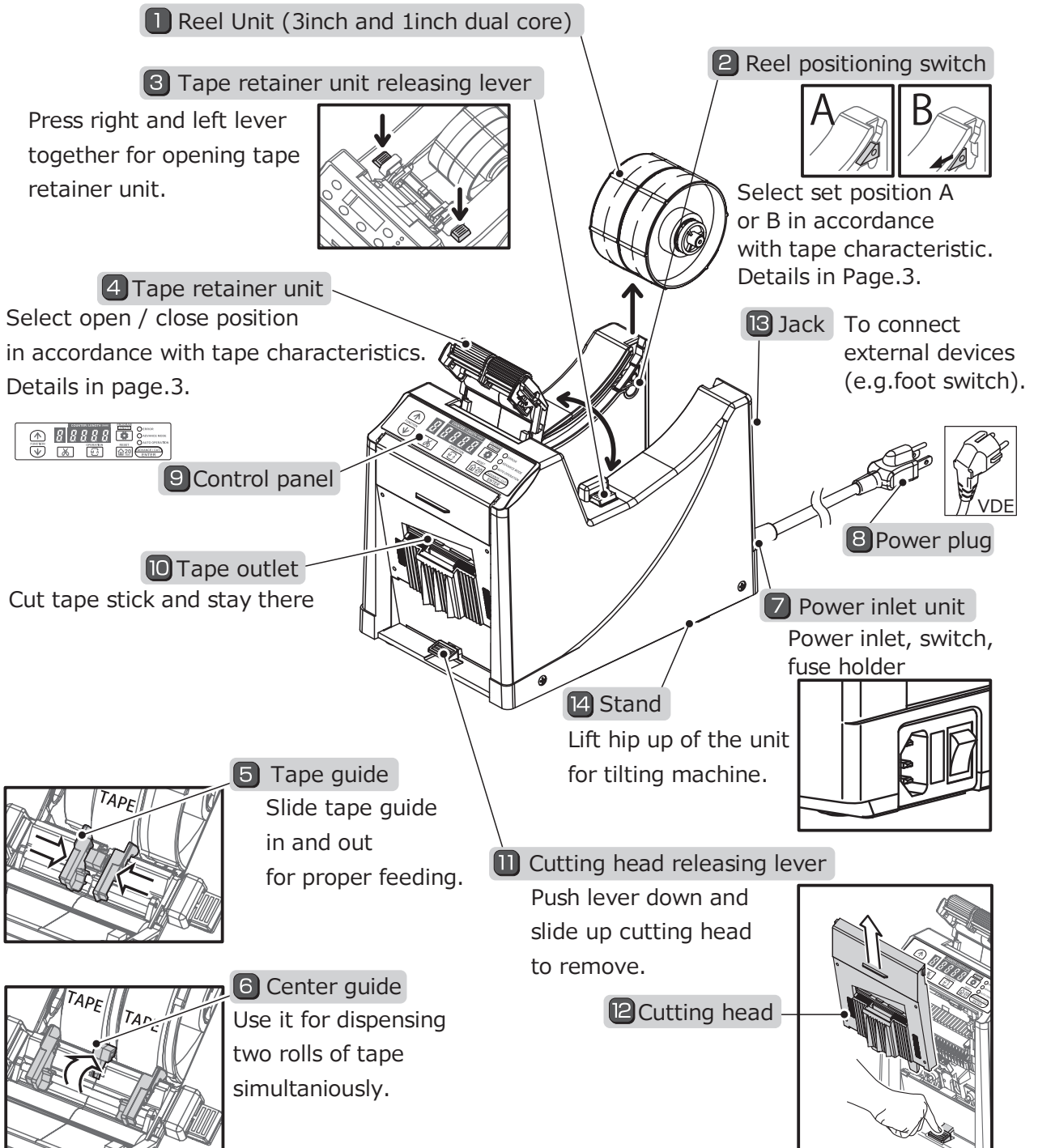

Set reel position

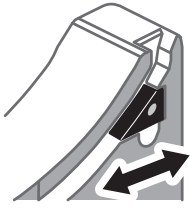

2

Reel positioning switch

Right and left sides need to be in the same position.

Reel positioning switch	Tape Retainer unit	For
<p>A</p>	Closed	Most tapes
	Open	For tape tends to curl up (e.g. thin film tape)
<p>B</p>	Closed	Depends on tape characteristic
	Open	Depends on tape characteristic

Tape setting



Warning

Do NOT insert your fingers into cutting head.

How to use 1 Reel unit

Take 1 Reel unit out from the unit and set tape on center of the reel.

Press 3 Tape retainer releasing lever.

Remain 4 Tape retainer unit open.

Select reel position A or B by 2 Reel positioning switch.

** For narrow tapes (less than 10mm wide), ensure it passes over the left or right sensor.

1 Reel unit (3inch & 1inch)

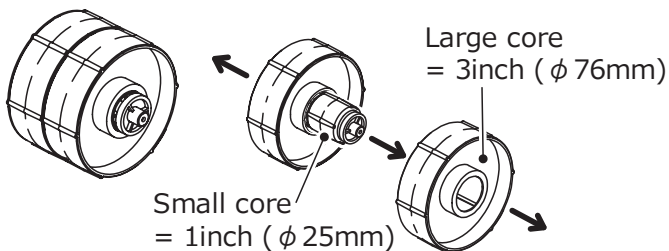

Wrap tape around the reel when core is loose.

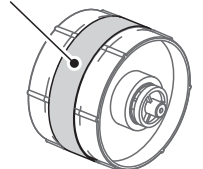

Tape set example

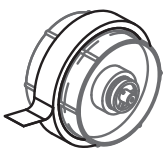

Dispensing a roll of tape

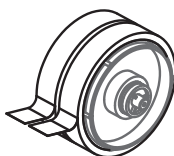

Dispensing 2 rolls of tape

** when dispensing two rolls of tape the type, width, and outside dia. need to be the same.



Narrow tape

** Ensure it passes over left or right sensor



Small dia. tape

Dispenser placement



Warning

DO NOT insert your fingers into cutting head.

Plug in and turn the **8 Power switch** ON.

LED display on the **9 Control panel** lit &  or the last saved length will be shown.

There are 3 different setting ways:

1: **Regular placement** (horizontal). 2: **Frontal tilt** (For dispensing long pieces of tape)



3: **Wall Mounting** (For extra long pieces)

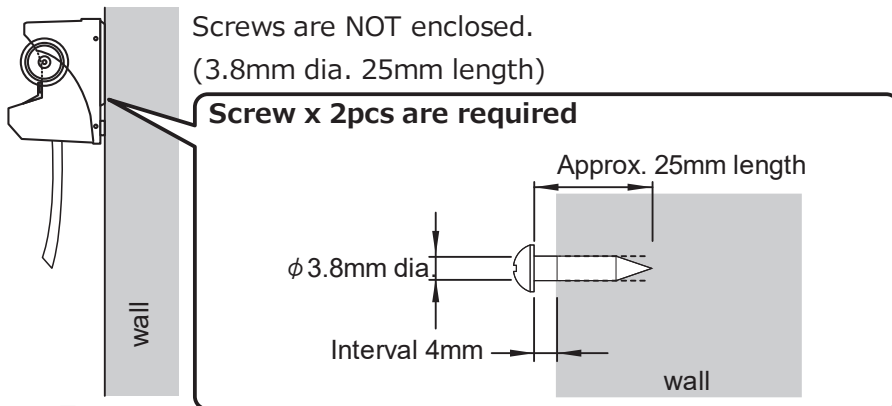

Bottom

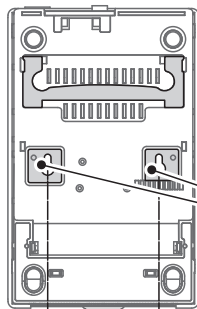

2 holes for screw head

80mm interval in between holes.

Mount at your own risk.



When wall mounting consider:

- Only use with tapes with enough tack. (Low adhesive tape will fall after cut)
- Do not place under strong air flow (in front of fan, A/C, etc.)
- Mount on hard surface and safe location.

BASIC mode

Caution Keep body parts away from moving parts.

Warning Do NOT insert your fingers into cutting head.

9 Control panel (Buttons)

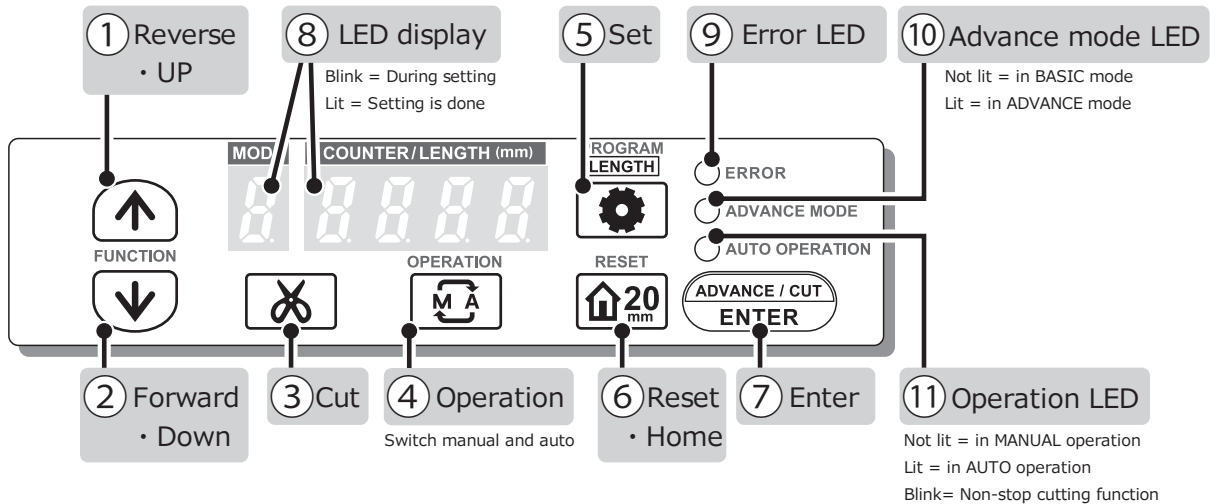

 Caution	Keep body parts away from moving parts.
--	---

Initial tape setting

Fold corners of the tape to form a trapezoid shape.

Stick it onto feed roller.

(White mark= center of the roller)

Press ②  few times until tape feeds through

⑩ **Cutting head** for about 3-4cm.

Close ④ **Tape retainer unit**.

Adjust ⑤ ⑥ **Tape guide** in accordance with tape width.

Press ③  **Cut button** and remove cut tape.

Ready to go

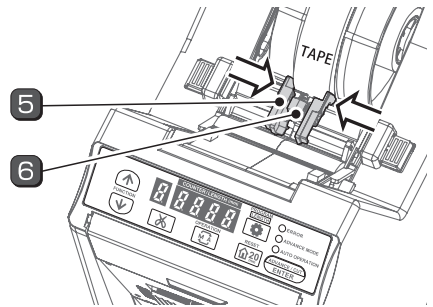
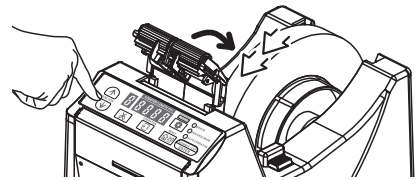
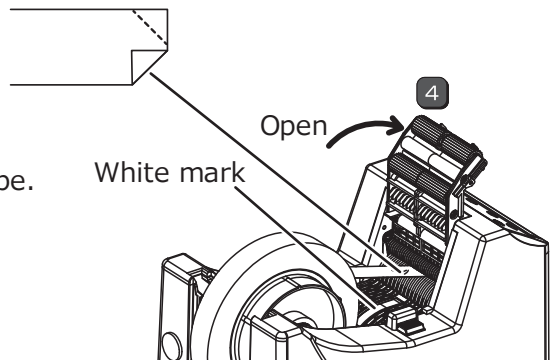
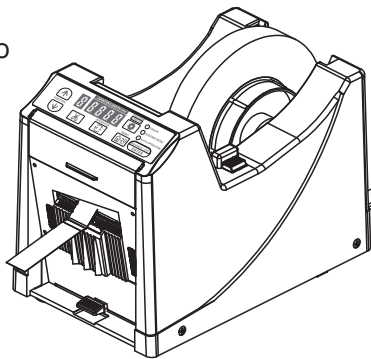



 **Advance and reverse feed roller**

Press ②  to advance. Used for setting up

Press ①  to reverse. Used for tape change or if jammed.

Setting tape length (5mm - 9,999mm in 1mm interval)

Press ⑤  .  will be shown in ⑧ LED. (Be able to show length from 5 - 9,999mm)

Press ①  for UP and ②  for DOWN. (Keep pressing button for quick change)

Once desired length is set, press ⑦  to confirm.

Once display stop blinking, length is confirmed.

*** Press and hold ⑥  to reset initial length .

 Warning	DO NOT insert your fingers into cutting head. For your safety, use tweezers to retrieve pieces shorter than 20mm.
--	--

MANUAL operation

Whenever **7** is pressed, set length is fed and cut.

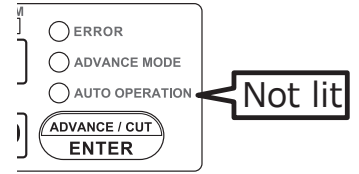

AUTO operation

Press **4** . **11** **AUTO operation LED** will be lit.

Press **7** for dispensing initial tape out & remove it. Remove a piece of tape from machine. Another piece will be fed and cut automatically.

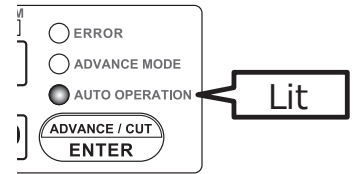

Do NOT remove tape too fast. will be caused.

For tape that tends to curl. Keeping **4** **Tape retainer unit** open could be helpful.

Press **4** to return to MANUAL operation.

After shift unload the tape to prevent jamming when starting next shift.

DO NOT pull tape from dispenser before cutting is completely done. It may cause error.

Fix the cause of tape jamming and press **6** twice to remove error message.

See page 9 for troubleshooting.

How to change mode

Press and hold **6** , to return to original settings.

Configuration Diagram

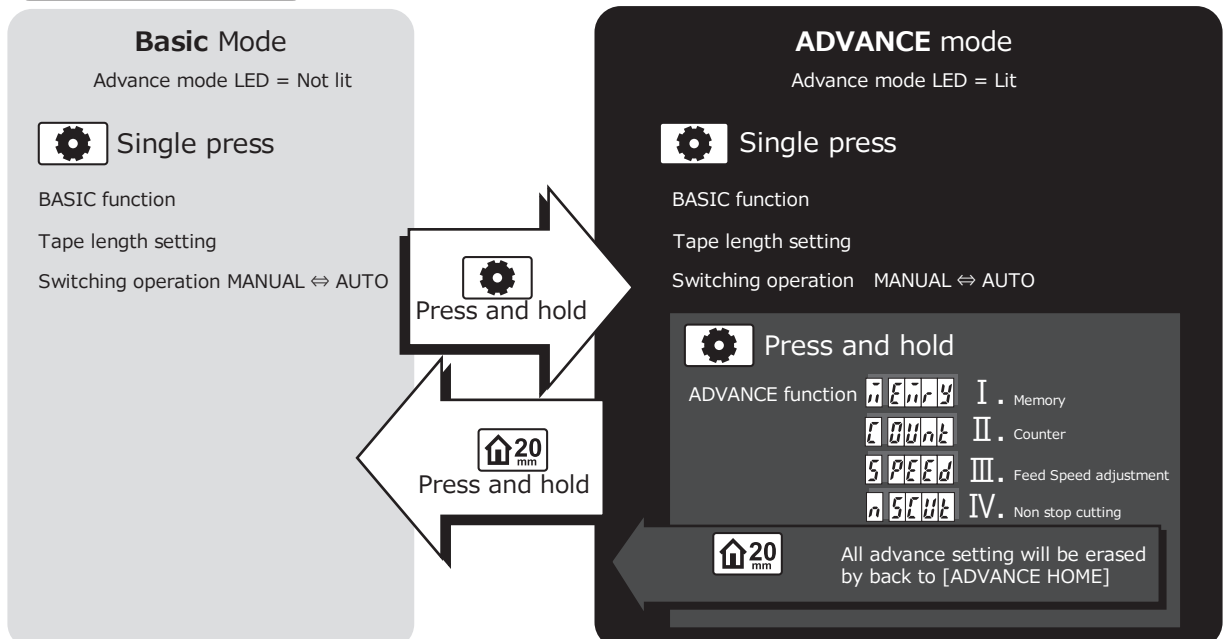

After shift

After every shift, always remove the tape. Leaving it on can cause jamming during the next shift, as the adhesive bond to the rollers strengthens over time.

Sensor

Reflecting sensor detects the presence of tape.
For proper operation, avoid setting in direct light.
Do not place the unit under very bright environments,
detection may fail.

Recommended illumination environments:

Fluorescent lamps: Less than 3,000lx (40W, about 30cm distance)

LED lamps : Less than 3,000lx

Sun light : Less than 10,000lx

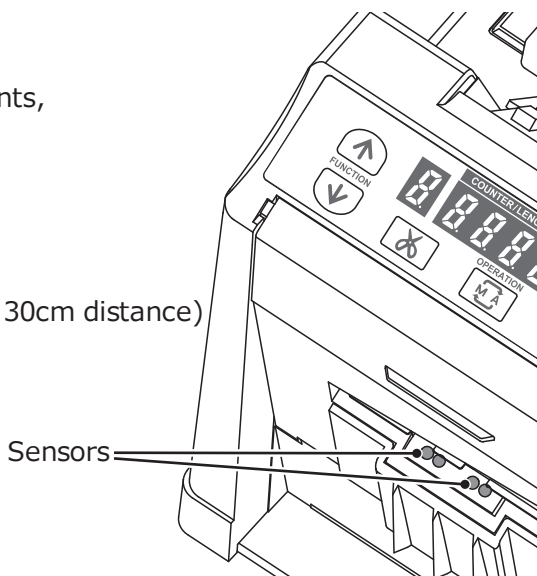

** DO NOT operate outdoors



Troubleshooting

 Warning DO NOT insert your fingers into cutting head.

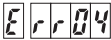
When an error occurs, ⑨Error LED lights in red and machine stops.
Error number will be Shown in ⑧LED display.

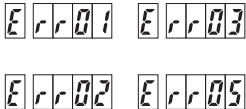
Indication	Causes and Solutions
 Error 04	1) Out of detecting distance due to tape curling up. Make adjustment either ④ tape retainer unit open/close or tape set position A/B by ② reel positioning switch speed. 2) Pulled tape too fast. Pull tape once the cycle is complete. 3) Cut has been made but no tape is present. Load tape and press  twice. If none of these steps resolve the problem, the sensor may be malfunctioning. Consult with us or your dealer.
 Hitemp	Overheated. Let machine cooldown for at least 30 mins.
 Error 01,02,03,05	Parts worn out or failure can be the reason. Stop using unit and consult with us or your dealer for repair and maintenance details.

How to release tape jamming

Open ④ **Tape retainer unit**. Press ①  couple times to run feed roller backwards.
Cut wrinkled tape out.



Caution

Turn switch [OFF] to prevent unexpected operation.

When tape is heavily jammed:

Remove ⑫ **Cutting head** & remove jammed tape with tweezers.

If tape is wrapped around feed roller, remove tape with scissors.

Make sure blades are in the right position and put ⑫ **Cutting head** back to the machine.

Inside of cutting head



Correct setting

Upper blade

Lower blade

No gap

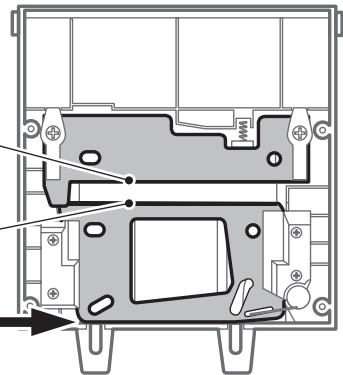

Wrong setting

Upper blade

Lower blade

Some space

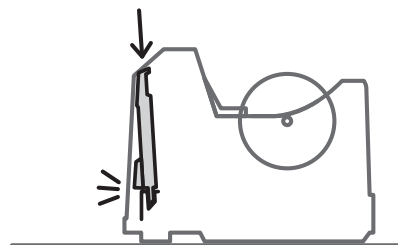
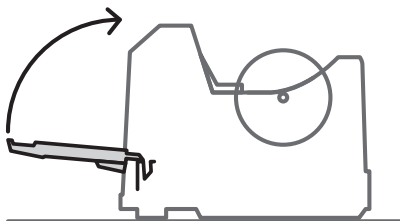
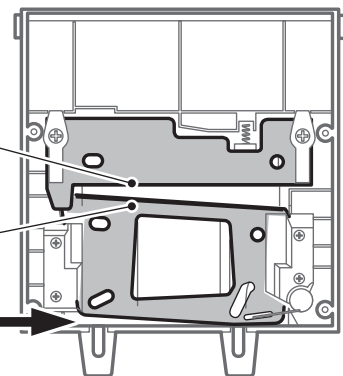

Product specifications

Model No.	TDA060
Display	1+4 digits LED
Applicable tape width	5~60mm
Cut length	5~9,999mm (1mm interval)
Core (Reel) diameter	3 inch (φ 76mm) , 1 inch (φ 25mm)
Max outside dia. of tape	Max φ 190mm (7.48inch)
Compatible with	Cellophane, Mending, Kraft, Cloth, PP, Double-sided, Filament, PPE, PE, Polyimide (Kapton) tapes, and non-adhesive materials (Tubbing, ribbon, etc.) * Dispenser may experience difficulty feeding or cutting tapes with the following characteristics: Curling, strong adhesive, high transparency, extremely thin, slippery, static-generating, and other uncommon characteristics.
Drive	DC motor for tape feeding and cutting
Power consumption	28W
Power (AC)	100-240VAC 50/60Hz
Ambient Light	Fluorescent lamps: Less than 3,000lx (40W, about 30cm distance) LED lamps: Less than 3,000lx Sun light: Less than 10,000lx ** DO NOT operate outdoors
Ambient temp & humidity	5°C - 40°C (41°F - 104°F) , 80% humidity or less
Size (W x L x H)	(W)137 X (L)215 X (H)169mm/ (W)5.4 X (L)8.5 X (H)6.7in.
Weight	1.75 Kg (3.86 lb)
Cabinet material	ABS-V0
Country of origin	Japan
Enclosed	Machine, Reel unit, Power cord, Fuse (Inside of fuse holder)

* Accuracy of cut is about ±2mm (Depending on tapes)

* Specifications are subject to change without notice.



START International

4270 Airborn Dr. Addison, TX 75001, U.S.A.

Tel : +1 972.248.1999

Fax: +1 972.248.1991

✉ info@STARTinternational.com

www.STARTinternational.com



ECT Inc.

3-13-8-4F Minami Ikebukuro Toshima-Ku, Tokyo, 171-0022 JAPAN

Tel : +81-3-5924-6677

Fax: +81-3-5924-6456

✉ info@ectinc.co.jp

www.ectinc.co.jp